

High Power

SEN Louvre CV 035 Fixture Guide



Indoor/Outdoor | Surface | Output up to 2644lm/m (806lm/ft)



Key applications

- ✓ Ceiling
- ✓ Ceiling pendant
- ✓ Direct lighting
- ✓ Downlighting
- ✓ Exterior
- ✓ Interior
- ✓ Office lighting
- ✓ Retail display
- ✓ Wall grazing

Key features

- ✓ Adjustable
- ✓ Custom lengths
- ✓ Constant Voltage (CV)
- ✓ Diffusion: spotting
- ✓ Direct view
- ✓ IP44 moisture resistant
- ✓ IP67 waterproof
- ✓ Lens options

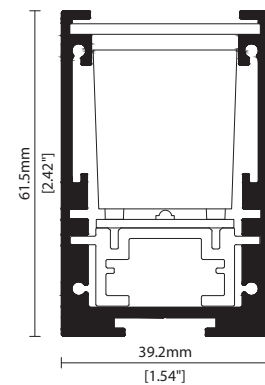

MOUNTING METHODS



KKBK-02 Fixed bracket



KKBK-09 Mounting plate



KKBK-16 Small adjustable bracket



KKBK-17 Large adjustable bracket



KKBK-23 Low adjustable bracket



KKSU-05 Quick release suspension wire kit



SEN Louvre CV 035

Specification sheet



Dimensions	H61.5/W39.2/L260-2010mm (H2.42/W1.54/L10.24-79.13in) 1260mm (49.60in) max for UL
PCB Cut-point	250mm (9.84in)
LED Pitch	35mm - 28LED/m (1.38in - 9LED/ft)
Chip	h-line
Cover/Optics	10°/20°/30°
CCT	h-line: 2700K/3000K/3500K/4000K/5000K (90CRI for 2700K/3000K)
LED binning	h-line: 3-step MacAdam Ellipse h-line: 4-step MacAdam Ellipse(5000K)
CRI	≥ 90 (2700K/3000K) ≥ 80 (3500K/4000K/5000K)
Lifetime	50,000 hours @ 25°C (50,000 hours @ 77°F)
Operating temp	T _a = -25 to 45°C (T _c max = 80°C) T _a = -13 to 113°F (T _c max = 176°F)
IP Rating	IP44/67
Finish	Silver anodised
Mounting	Surface mounting via brackets
Power feed	Sheathed hardwire tails or male/female connectors
Control	1-10V/DMX/DALI

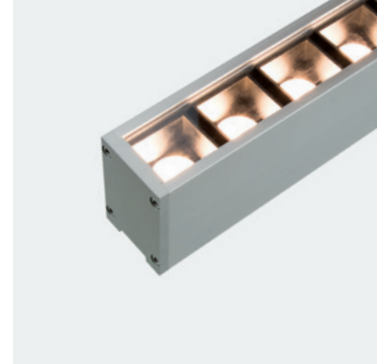

LED Grading Key

Exclusive Grade

h-line*	*KKDC tuned
Constant Voltage Lensed High Power LED	CCT range
3-step CCT range	
(4-step for 5000K)	

Power consumption	Supply voltage	Supply current
40W/m (12.19W/ft)	24V DC	1.67A/m (0.51A/ft)

	Clear Cover 10°	Clear Cover 20°	Clear Cover 30°	CRI	R9	Rf	Rg
h-line	2188lm/m (667lm/ft) 54.7lm/W	2308lm/m (703lm/ft) 57.7lm/W	2644lm/m (806lm/ft) 66.1lm/W	94	65	-	-

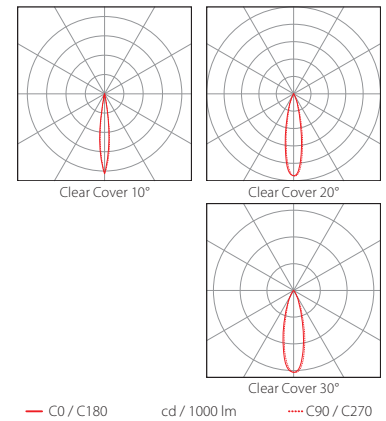
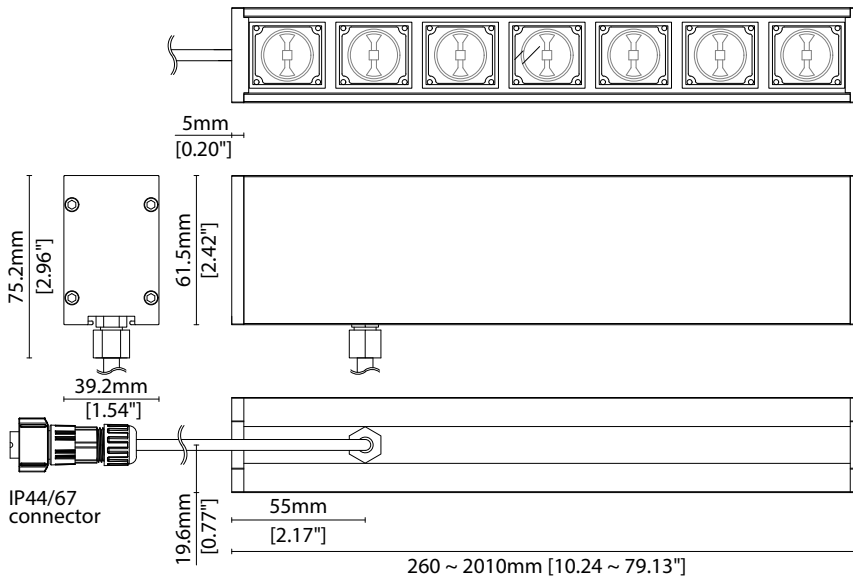

Data derived from independent UKAS/IESNA LM-79-08 accredited testing of production samples.



SEN Louvre CV 035

Code Table



FIXTURE

Model	Finish	Cover/Lens ¹	Grade ²	LED	Colour (CCT)	Length Availability ³	IP	Cable Length	Power Feed ⁴	Cable Exit ⁵	Lens	Input			
SEN Louvre	SV Silver Anodised	Clear	B	h	L35	2700K ⁶ 27	m 260-2010mm 250mm increments	IP44 44 IP67 ⁷ 67	1000mm 1000 /39.37"	Single ø6.3mm sheath tail	S00B	Rear Cable Exit RC	10° 10	DC 24V g	
					3000K ⁶ 30	10.24-79.13in 9.84in increments				Double ø6.3mm sheath tail	D00B	Side Cable Exit ⁸ SC	20° 20		
					3500K 35					Single ø6.3mm sheath IP67 connector	S67B	30° 30			
					4000K 40								Double ø6.3mm sheath IP67 connector		D67B
					5000K 50										

¹ Refer to **Cover/Lens Options** on **Options** pages

² Refer to **LED Grading Key** on **Specification sheet** page

³ Refer to **Length Availability List** or enter total run length instead of length code

⁴ Refer to **Power Feed Options** on **Options** pages

⁵ Refer to **Cable Exit Options** on **Options** pages

⁶ 2700K/3000K – 90CRI

⁷ Due to the clear, flush potted polyurethane top layer on IP67 SEN a colour shift of +/-20K should be expected

⁸ Low adjustable bracket needs side cable exit option

Code Example:

SV	-	SA	-	B	-	h	-	L35	-	30	-	m	1010	-	67	-	1000	-	D67B	-	RC	-	30	-	g
SEN Louvre		Silver Anodised		Clear		h		035		3000K		1010mm		IP67		1000mm/39.37"		Double ø6.3mm sheath IP67 connector		Rear Cable Exit		30°		DC 24V	

ACCESSORIES

Mounting Accessories

KKBK-02	Fixed bracket
KKBK-09	Mounting plate
KKBK-16	Small adjustable bracket
KKBK-17	Large adjustable bracket
KKBK-23	Low adjustable bracket
KKSW-05	Quick release

* Refer to **Mounting accessories** on **Accessories** pages

Exterior Junction Boxes

KKJB-07	IP67 Slim J-Box
KKJB-07R	Potting Resin for IP67 Slim J-Box

* Refer to **Exterior Junction Boxes** on **Accessories** pages

PSU/Driver

1-10V/DALI/DMX

* Refer to **Driver/PSU Options** page for details or provide requirement and KKDC to offer the suitable option

High Power

SEN Louvre CV 035

Length Availability List



Length Code		Fixture Length ¹		LED Strip ²		End Cap Dimension ³		Wattage (W)	Output (lm)
Metric	Imperial(US)	Metric	Imperial(US)	Metric	Imperial(US)	Metric	Imperial(US)		3000K (Test Data)
m0260	i0010	260mm	10.24in	250mm	9.84in	10mm	0.39in	12.50	726
m0510	i0020	510mm	20.08in	500mm	19.69in	10mm	0.39in	25.00	1453
m0760	i0030	760mm	29.92in	750mm	29.53in	10mm	0.39in	37.50	2179
m1010	i0040	1010mm	39.76in	1000mm	39.37in	10mm	0.39in	50.00	2905
m1260	i0050	1260mm	49.61in	1250mm	49.21in	10mm	0.39in	62.50	3631
m1510	i0059	1510mm	59.45in	1500mm	59.06in	10mm	0.39in	75.00	4358
m1760	i0069	1760mm	69.29in	1750mm	68.90in	10mm	0.39in	87.50	5084
m2010	i0079	2010mm	79.13in	2000mm	78.74in	10mm	0.39in	100.00	5810

¹ Actual total overall length of light fixture (LED strip + end caps + void/wire hole)

² Actual length of PCB strip

³ Actual length of 2x end caps

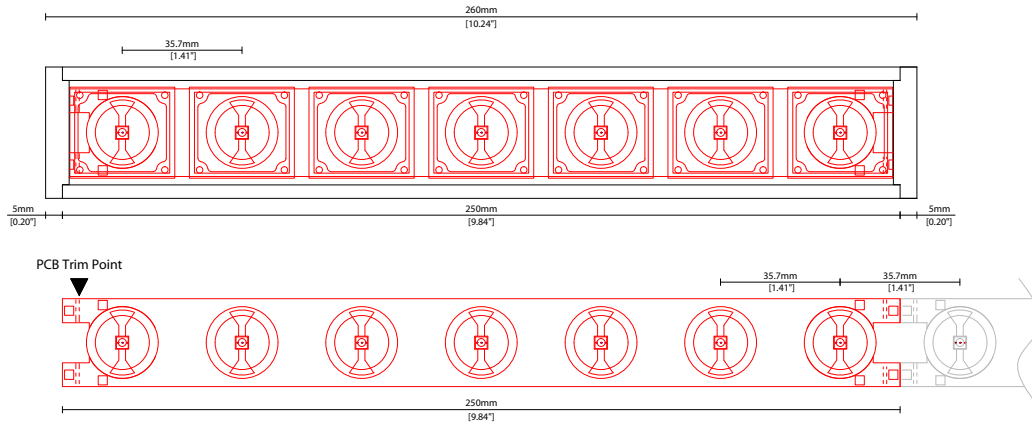



SEN Louvre CV 035 Options



COVER LENS OPTIONS

* Options are an integral part of the fixture ordering codes. Please refer to **Code Table** pages.



B 10 Clear cover 10° lens
W39.2/H43.2mm (W1.54/H1.70")

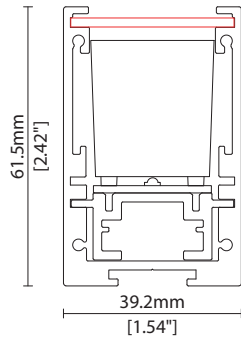

B 20 Clear cover 20° lens
W39.2/H43.2mm (W1.54/H1.70")

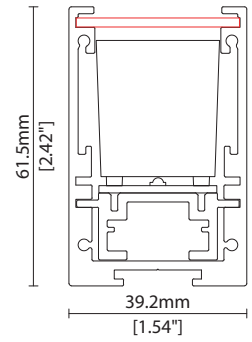

B 30 Clear cover 30° lens
W39.2/H43.2mm (W1.54/H1.70")

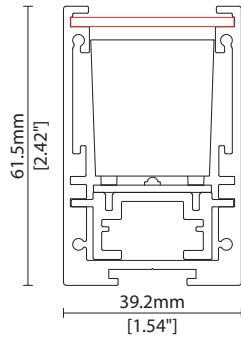

CABLE EXIT OPTIONS



RC Rear cable exit

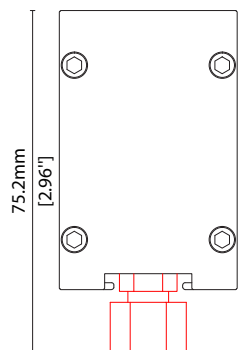

SC Side cable exit

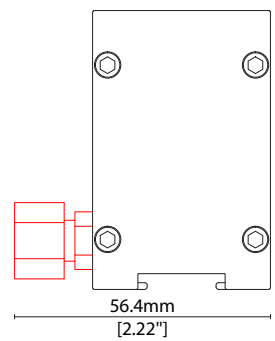

POWER FEED OPTIONS

1000 S00B 1000mm (39.37") Single ø6.3mm sheath tail

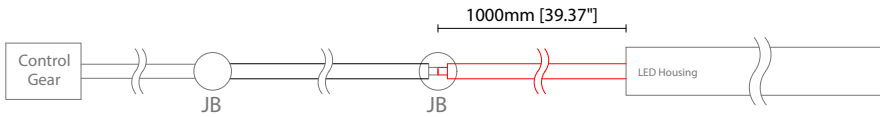

1000 D00B 1000mm (39.37") Double ø6.3mm sheath tail

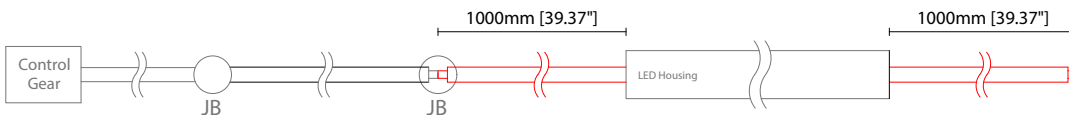

1000 S67B 1000mm (39.37") Single ø6.3mm sheath connector IP67 (Premoulded)

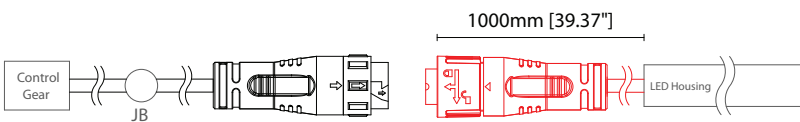

1000 D67B 1000mm (39.37") Double ø6.3mm sheath connector IP67 (Premoulded)

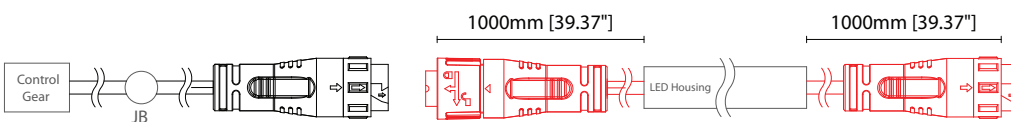

2 Pin Female Connector IP67 (Premoulded)

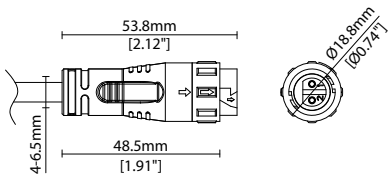

2 Pin Male Connector IP67 (Premoulded)

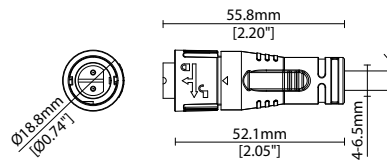

Key

- Control Gear Power supply, sub-controllers & control systems
- JB Junction box / cable connection

High Power

SEN Louvre CV 035 Accessories

KKDÖ

MOUNTING ACCESSORIES

Note: Accessories are to be ordered separately with corresponding code shown below.



KKBK-02

Fixed bracket (allow 2 per metre/40in)

S/Steel finish

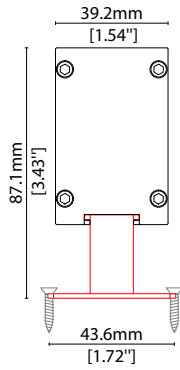

KKBK-09

Mounting plate (allow 2 per metre/40in)

Silver anodised aluminium finish

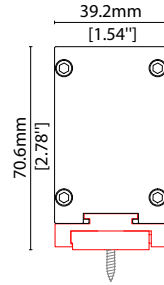

KKBK-23

Low adjustable bracket (allow 2 per metre/40in)

Silver anodised aluminium finish

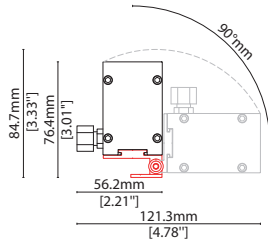

KKBK-16

Small adjustable bracket (allow 2 per metre/40in)

Silver anodised aluminium finish

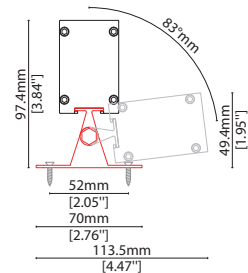

KKBK-17

Large adjustable bracket (allow 2 per metre/40in)

Silver anodised aluminium finish

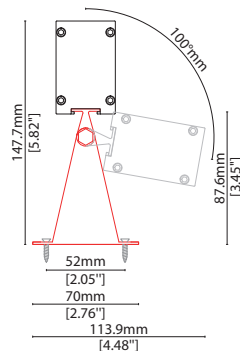

KKSW-05

Quick release suspension wire kit (1x pair of cables will support up to 2010mm length).

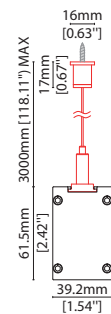



SEN Louvre CV 035 Accessories



EXTERIOR JUNCTION BOXES



KKJB-07

IP67 Slim J-Box
(including type A,B,C,D bushings)



KKJB-07R

Potting resin for IP67 Slim J-Box



SEN Louvre CV 035

Driver/PSU Options



AVAILABLE PSU OPTIONS

Control Mode	PSU (Order Code)	Input Voltage AC	Output Voltage DC	Rated Output Current	Rated Power	Dim %	IP Rating
Switched	CEN-60-24	90-295V	24V	2.5A	60W	-	IP67
	HLG-60H-24	90-305V	24V	2.5A	60W	-	IP67
	HLG-100H-24	90-305V	24V	4.0A	100W	-	IP67
	HLG-150H-24	90-305V	24V	6.3A	150W	-	IP67
	HLG-240H-24	90-305V	24V	10A	240W	-	IP67
0-10V (1-10V)	PWM-40-24	90-305V	24V	1.67A	40W	100-0.15 (100-10)	IP67
	PWM-60-24	90-305V	24V	2.5A	60W	100-0.15 (100-10)	IP67
	PWM-90-24	90-305V	24V	3.67A	90W	100-0.15 (100-10)	IP67
	PWM-120-24	90-305V	24V	5.0A	120W	100-0.15 (100-10)	IP67
DALI	LIN100A1	120-277V	24V	1A per channel	100W	100-0.1	IP66/IP40
DMX RGB	LIN100A1	120-277V	24V	1.33A per channel	100W	100-0.1	IP66/IP40
DMX RGBW	LIN100A1	120-277A	24V	1A per channel	100W	100-0.1	IP66/IP40

Flicker Free Options - Combination of PSU+ sub-controller

Control Mode	PSU (Order Code)	Sub-controller (Order Code)	Input Voltage AC	Output Voltage DC	Rated Output Current	Rated Power	Dim %	IP Rating PSU/ Sub-controller
0-10V or 1-10V	CEN-60-24	KKDM-06	90-295V	24V	2.5A	60W	100-0.9	IP67/IP20
	HLG-60H-24	KKDM-06	90-295V	24V	2.5A	60W	100-0.9	IP67/IP20
	HLG-100H-24	KKDM-06	90-295V	24V	4.0A	100W	100-0.9	IP67/IP20
	HLG-150H-24	KKDM-06	90-295V	24V	6.3A	150W	100-0.9	IP67/IP20
	HLG-240H-24	KKDM-06	90-295V	24V	10.0A	240W	100-0.9	IP67/IP20
DALI	CEN-60-24	KKDL-02/03	90-295V	24V	2.5A	60W	100-0.1	IP67/IP20
	HLG-60H-24	KKDL-02/03	90-305V	24V	2.5A	60W	100-0.1	IP67/IP20
	HLG-100H-24	KKDL-02/03	90-305V	24V	4.0A	100W	100-0.1	IP67/IP20
	HLG-150H-24	KKDL-02/03	90-305V	24V	6.3A	150W	100-0.1	IP67/IP20
	HLG-240H-24	KKDL-02/03	90-305V	24V	10.0A	240W	100-0.1	IP67/IP20
DMX RGB	CEN-60-24	KKSC-05	90-295V	24V	2.5A	60W	100-0.9	IP67/IP20
	HLG-60H-24	KKSC-05	90-305V	24V	2.5A	60W	100-0.9	IP67/IP20
	HLG-100H-24	KKSC-05	90-305V	24V	4A	100W	100-0.9	IP67/IP20
	HLG-150H-24	KKSC-05	90-305V	24V	6.3A	150W	100-0.9	IP67/IP20
	HLG-240H-24	KKSC-05	90-305V	24V	10.0A	240W	100-0.9	IP67/IP20

¹ The items shown above cover the most frequently used specification but does not exhaust the possible options

² PSU and/or driver can be chosen from the table, or KKDC may recommend the best option upon receipt of the controls requirement and installation environment

³ Electrical shop drawing will include detailed information of PSU and relevant control drivers

⁴ Cut sheets are available on the controls section of www.kkdc.lighting or upon request